

Metropolitan Wastewater: City of Gosnells - Kenwick

NOTICE OF PROPOSAL TO CONSTRUCT INFILL SEWERAGE - STAGE 2A, 2B AND 2C

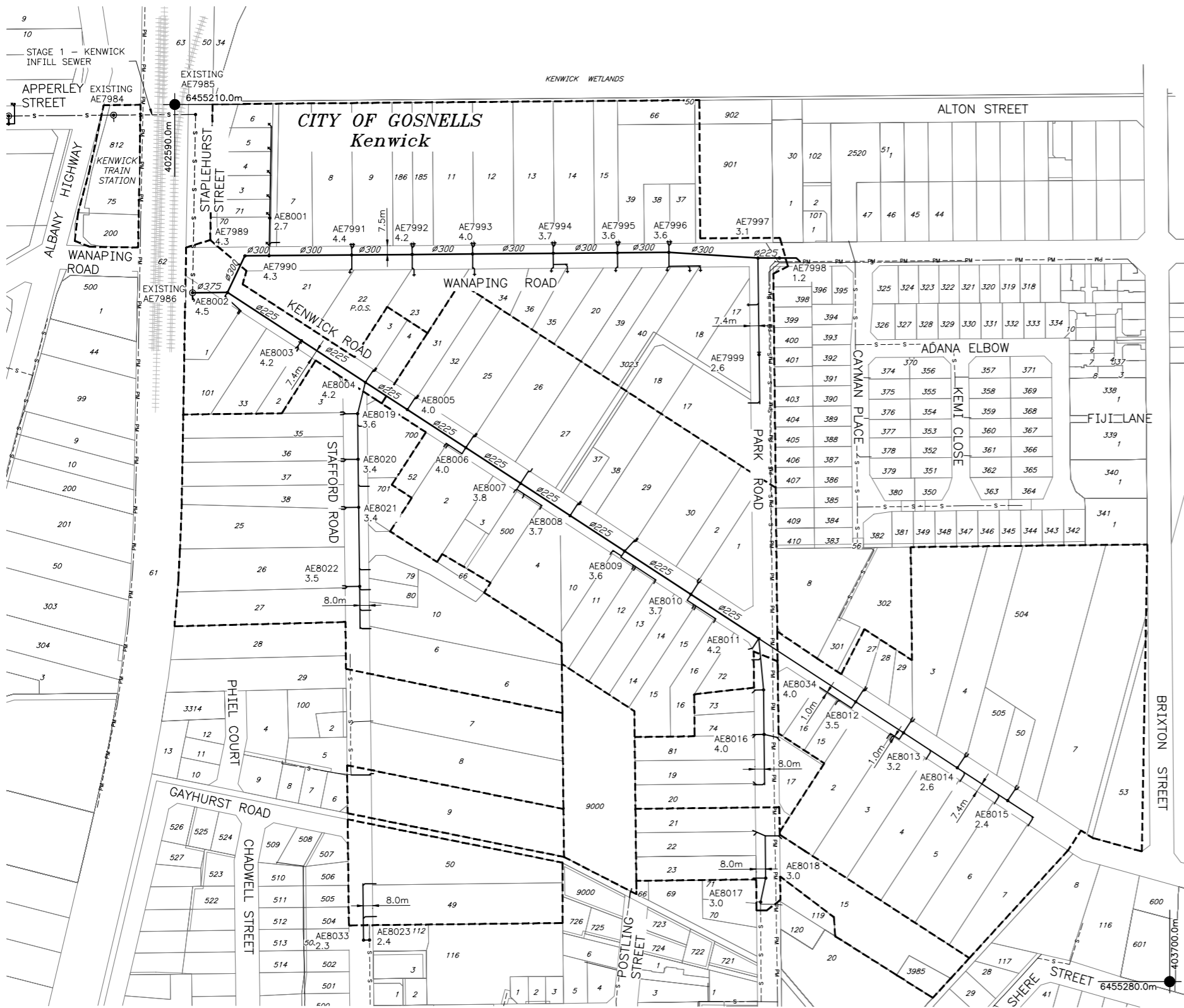

PLAN
SCALE 1:2000

To prepare for the connection of properties to Water Corporation's central wastewater system in the future, Water Corporation proposes to construct:

- approx. 29m below ground gravity sewers 375mm in diameter.
- approx. 479m below ground gravity sewers 300mm in diameter.
- approx. 535m below ground gravity sewers 225mm in diameter.
- approx. 1577m below ground gravity sewers 150mm in diameter.
- associated access chambers and inspection points.

The locations of the proposed works are shown on this plan. Further information may also be obtained by contacting the Project Manager, Sofia Vargas Pedroza, telephone 0408 320 285 during office hours or by email at Sofia.VargasPedroza@watercorporation.com.au.

Objections to the proposed works will be considered if lodged in writing, addressed to the Project Manager, Water Corporation, PO Box 100, Leederville, WA, 6902 in accordance with the instructions in the accompanying letter.

Further information is available on the Water Corporation's website at watercorporation.com.au/kenwickpipeline

NOTE

1. Centrelines of sewers at Access Chambers are as shown.
2. All sewers are 150mm diameter unless otherwise shown.

LEGEND

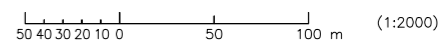
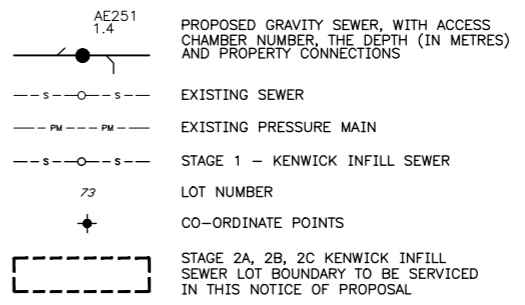

| | | | | | | | | | | | | | | | |
|-------|------|------|----------|-----|-----|------|----------------------------|--|-----------------------|-------------|-----------------------------|--|--|---------------------|----|
| ISSUE | DATE | GRID | REVISION | DRN | REC | APPD | DESIGN SURVEY NONE | VERTICAL DATUM NONE | DES CALC J.OVERHEU | NORTH POINT | RECOMMENDED | | METROPOLITAN WASTEWATER INFILL RETICULATION AREAS THORNIE 6W AND KENWICK 2R PREREQUISITES TO WORKS - GRAVITY SEWER EXTENSION NOTICE OF PROPOSAL - GENERAL WORKS - STAGE 2A, 2B AND 2C | ORIGINAL SHEET SIZE | |
| | | | | | | | ASCON SURVEY NONE | COORDINATE SYS MGA94-50 | DES CHD G. HARRIS | | CONSULTANT PROJECT MANAGER | | FILE | PROJECT CS03759 | A1 |
| | | | | | | | DES REF GHD 12633180 | DRN J.OVERHEU Q.C. CHD R.SPILLANE | | APPROVED | CONSULTANT PROJECT DIRECTOR | | PLAN | MQ15-0-2 | MF |