

Informal Verge Design

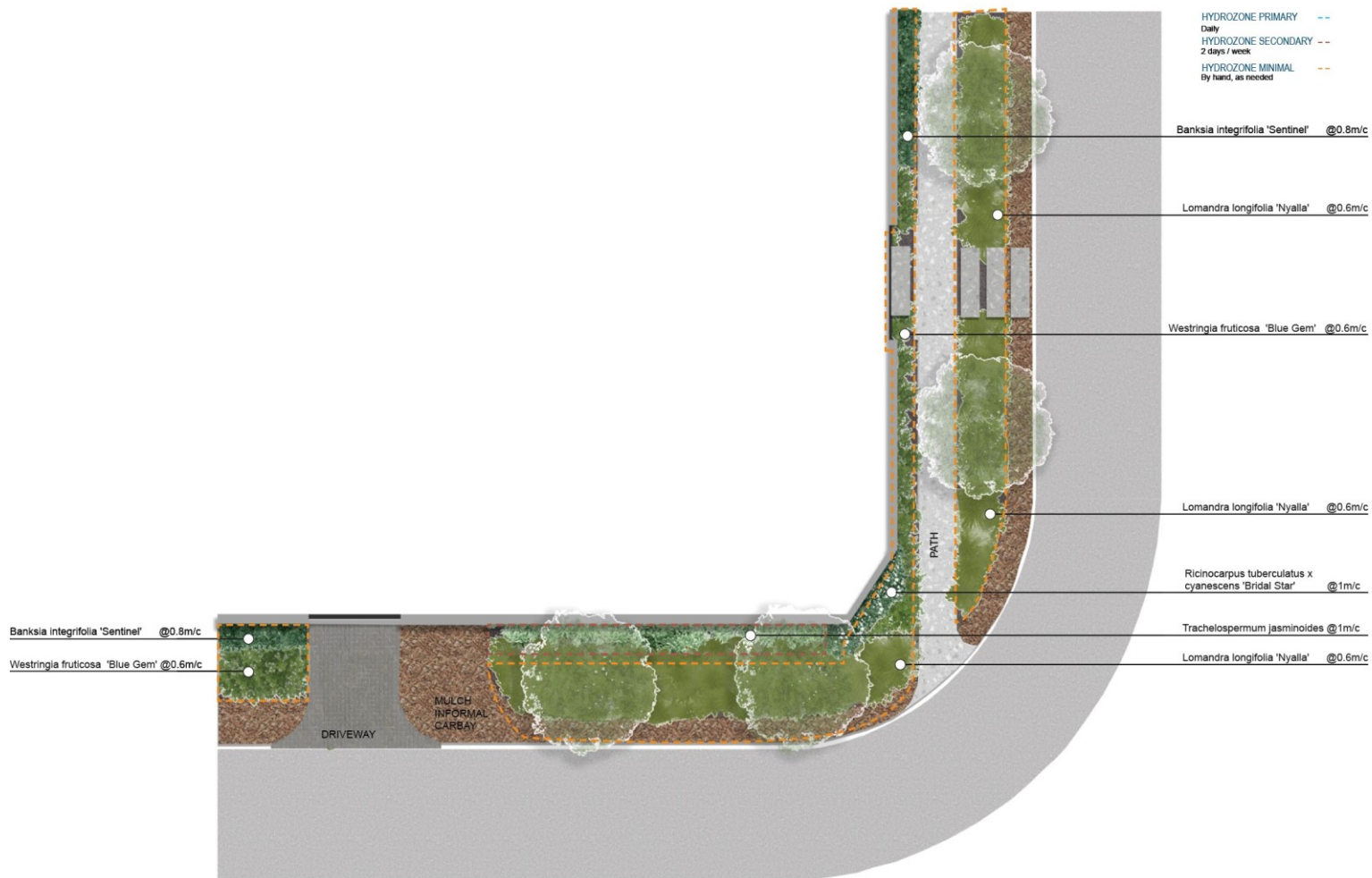

Note: m/c refers to the planting density ie 0.6m/c - leave 0.6 metre space between the centre stem of each of plant

Informal Verge Design

| Supplies | Plant Directory | | |
|--|--|--------------------|-------------------------|
| Likely soil type: Sandy soil Soil amendments: Bentonite clay, organic compost or soil wetting agent | <i>Botanical name</i> | <i>Common name</i> | <i>Planting density</i> |
| <i>Supplies you'll need to create this garden design</i> | Screening shrubs/Hedges | | |
| Seeds/plants | Ricinocarpus tuberculatus x cyanescens 'Bridal Star' | Wedding Bush | 1m/c |
| Stakes | Banksia 'Sentinel' | Coast Banksia | 0.8m/c |
| Organic Waterwise mulch 50-100mm thick | Westringia fruticosa 'Blue Gem' | Coastal Rosemary | 0.6m/c |
| Slow-release fertiliser | Climber | | |
| | Trachelospermum jasminoides | Star jasmine | 1m/c |
| | Strappy leaf | | |
| | Lomandra longifolia 'Nyalla' | Mat Rush | 0.6m/c |