

North West Mediterranean Garden Design

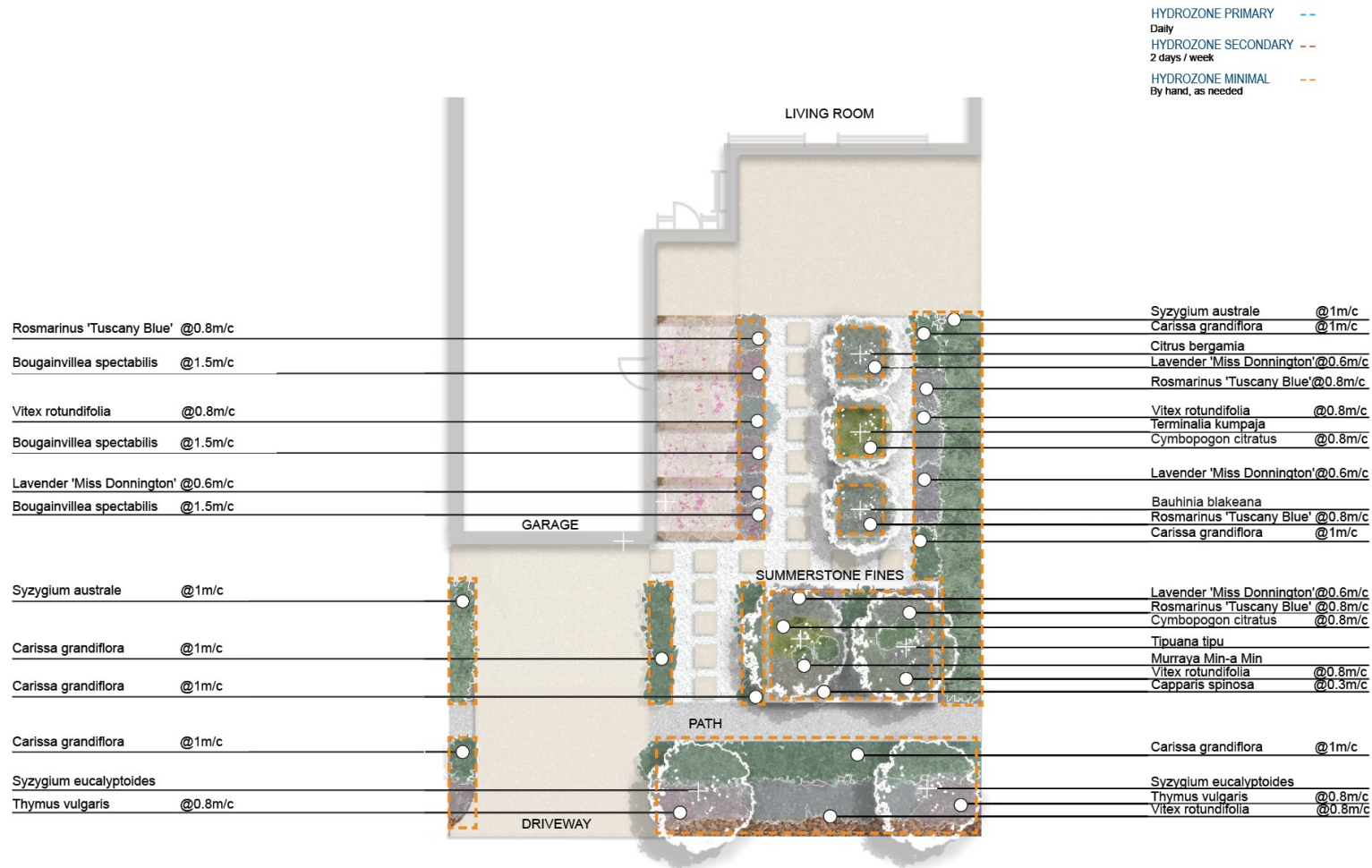

Note: m/c refers to the planting density ie 0.6m/c - leave 0.6 metre space between the centre stem of each of plant

North West Mediterranean Garden Design

Supplies	Plant Directory		
Likely soil type: Ironstone gravels, stony soils Soil amendments: Organic compost, soil wetting agent	<i>Botanical name</i>	<i>Common name</i>	<i>Planting density</i>
<i>Supplies you'll need to create this garden design</i>	Trees		
Seeds/plants	Bauhinia blakeana		
Stakes	Terminalia kumpaja	Pindan Quondong	
Organic Waterwise mulch 50-100mm thick	Syzygium eucalyptoides	Wide Apple	
Stepping stones	Tipuana tipu	Pride of Bolivia	
Stone mulch such as rainbow stone 20mm	Citrus bergamia	Bergamot Orange	
Raised garden edging	Strappy		
Slow-release fertiliser	Cymbopogon citratus	Lemongrass	0.8m/c
	Screening shrubs/Hedges		
	Syzygium australe	Brush Cherry	1m/c
	Carissa grandiflora	Natal Plum	1m/c
	Medium shrubs		
	Capparis spinosa	Caper Bush	0.3m/c
	Murraya Min-a-Min	Dwarf Mock Orange	As shown

North West Mediterranean Garden Design

	Lavender 'Miss Dorrington'	French Lavender	0.6m/c
	Rosmarinus 'Tuscany Blue'	Rosemary	0.8m/c
	<i>Groundcovers</i>		
	Vitex rotundifolia	Beach Vitex	0.8m/c
	Thymus vulgaris	Wild Thyme	0.8m/c
	<i>Climber</i>		
	Bougainvillea spectabilis	Bougainvillea 'Temple Fire'	1.5m/c