

North West Coastal Garden Design

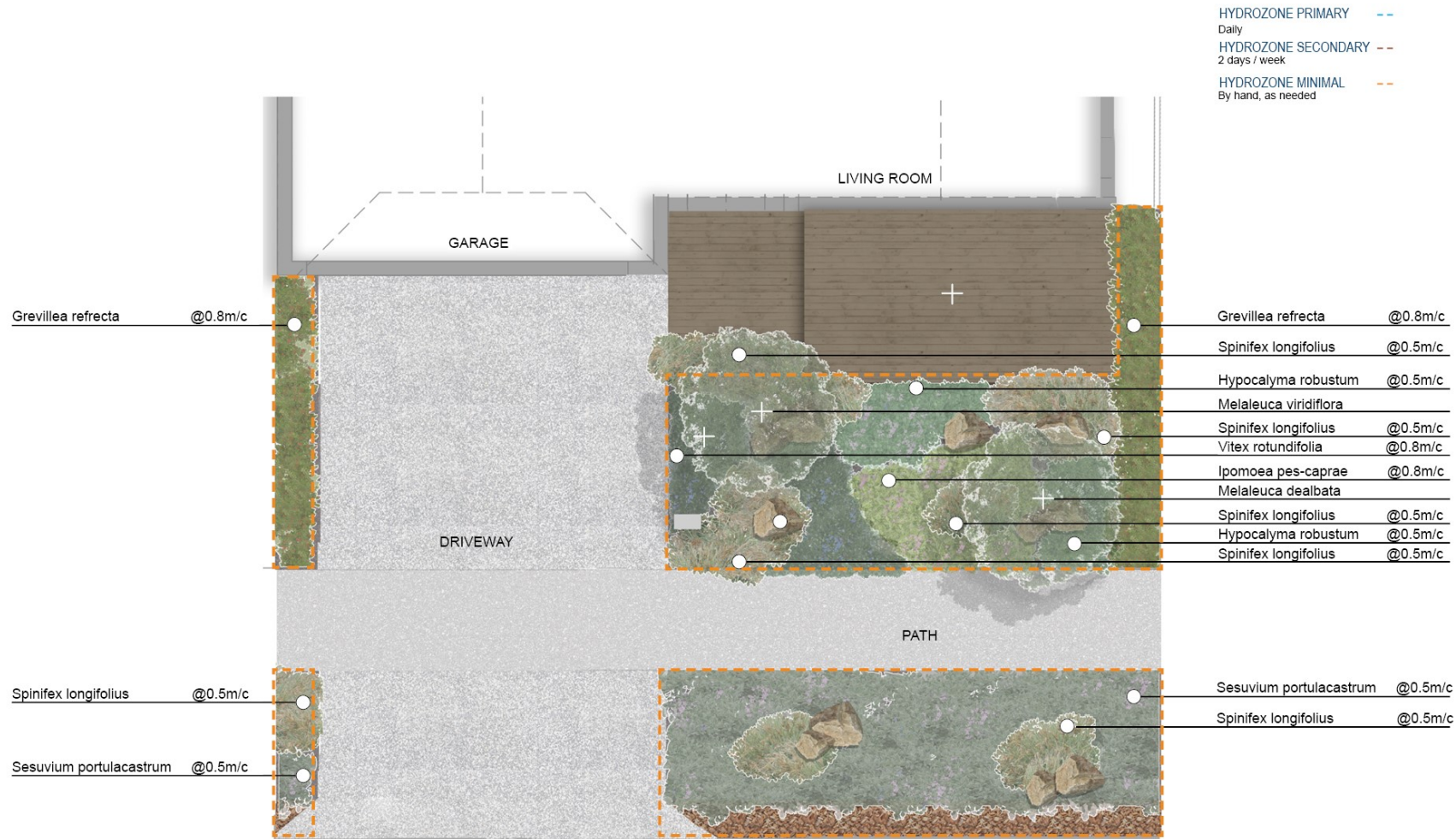

Note: m/c refers to the planting density ie 0.6m/c - leave 0.6 metre space between the centre stem of each of plant

North West Coastal Garden Design

Supplies	Plant Directory		
Likely soil type: Sandy soil Soil amendments: Bentonite clay, organic compost or soil wetting agent	<i>Botanical name</i>	<i>Common name</i>	<i>Planting density</i>
<i>Supplies you'll need to create this garden design</i>	<i>Trees</i>		
Seeds/plants	Melaleuca dealbata	Kambor	
Stakes	Melaleuca viridiflora	Broadleaf Paperbark	
Organic Waterwise mulch 50-100mm thick	<i>Screening shrubs/Hedges</i>		
Feature boulders	Grevillea refrecta	Silver Leaf Grevillea	0.8m/c
Slow-release fertiliser suitable for natives	<i>Medium shrubs</i>		
	Hypocalyma robustum 'Pink Myrtle'	Swan River Myrtle	0.5m/c
	Spinifex longifolius	Beach Spinifex	0.5m/c
	<i>Groundcovers</i>		
	Ipomoea pes-caprae	Beach Morning Glory	0.8m/c
	Sesuvium portulacastrum	Sea Purslane	0.5m/c

North West Coastal Garden Design

	Vitex rotundifolia	Beach Vitex	0.8m/c
--	--------------------	-------------	--------