

Mid West Coastal Garden Design

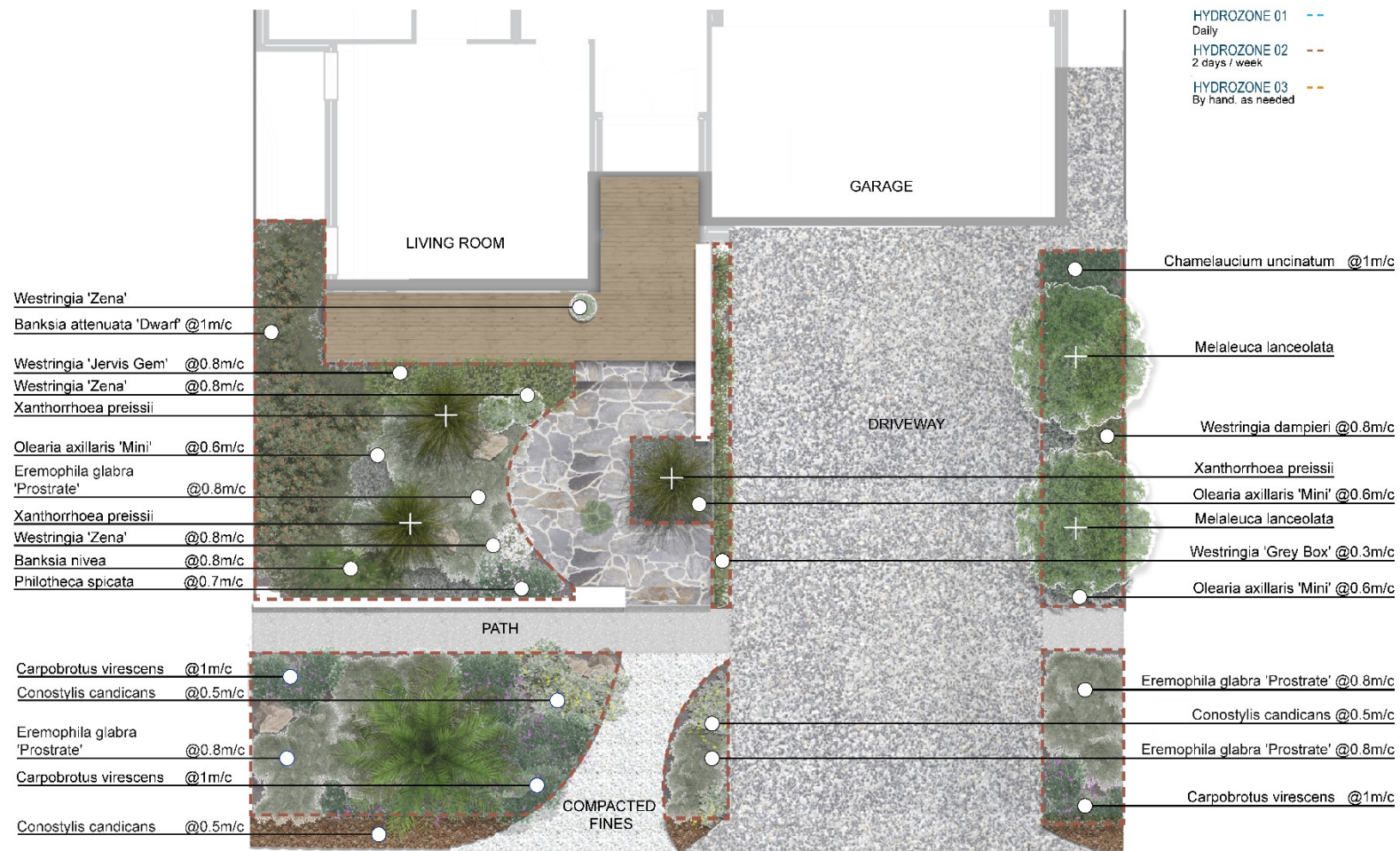

Note: m/c refers to the planting density ie 0.6m/c - leave 0.6 metre space between the centre stem of each of plant

Mid West Coastal Garden Design

Supplies	Plant Directory		
Likely soil type: Sandy soil Soil amendments: Bentonite clay, organic compost or soil wetting agent	<i>Botanical name</i>	<i>Common name</i>	<i>Planting density</i>
<i>Supplies you'll need to create this garden design</i>	Trees		
Seeds/plants	Melaleuca lanceolata	Moonah	
Stakes	Accent plants		
Organic Waterwise mulch 50-100mm thick	Xanthorrhoea preissii	Grass Trees	n/a
Slow-release fertiliser suitable for natives	Westringia 'Zena'	Coastal Rosemary	0.8m/c
	High shrubs/Hedges		
	Chamelaucium uncinatum	Geraldton Wax	1m/c
	Banksia attenuata 'Dwarf'	Sandplain Banksia (Not prostrate version)	1m/c
	Westringia dampieri	Shore Westringia	0.8m/c
	Westringia 'Jervis Gem'	Coastal Rosemary Jervis Gem	0.8m/c
	Medium shrubs		
	Banksia nivea	Honeypot Dryandra	0.8m/c
	Olearia axillaris 'Mini'	Coastal Daisy Bush	0.6m/c

Mid West Coastal Garden Design

	Westringia 'Grey Box'	Compact Coastal Rosemary (Not the mini version)	0.3m/c
	<i>Groundcovers</i>		
	Carpobrotus virescens	Coastal Pigface	1m/c
	Conostylis candicans	Grey Cottonheads	0.5m/c
	Eremophila glabra 'Prostrate'	Emu Bush	0.8m/c
	Philotheca spicata	Pepper and Salt	0.7m/c