

# Metropolitan Water: City of Perth - West Perth

## NOTICE OF PROPOSAL TO CONSTRUCT A PUMP STATION IN KINGS PARK

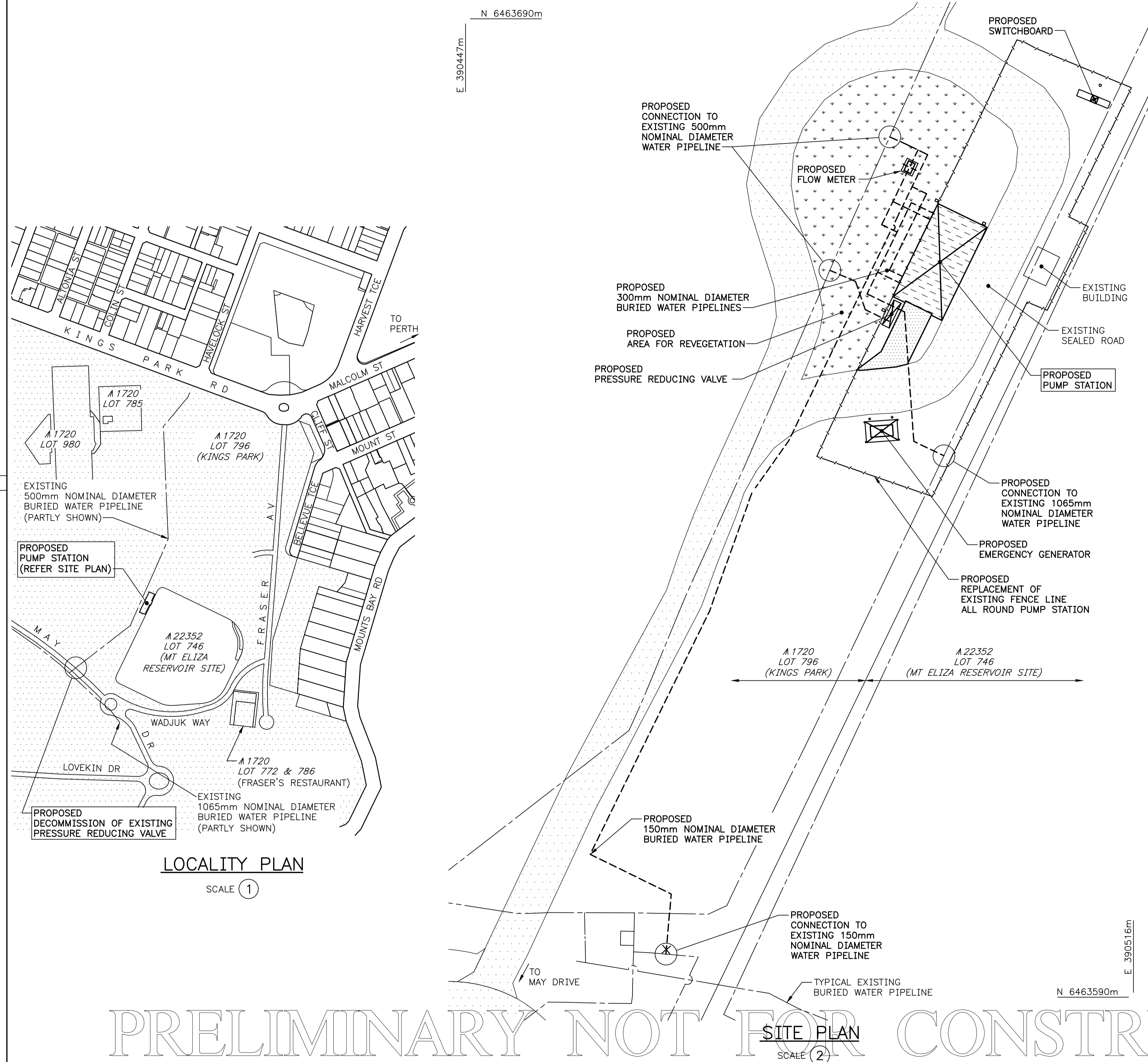

To integrate water supply from the Alkimos Seawater Desalination Plant (stage 1 currently under construction) into the Perth water supply network, increased capacity is required in the Serpentine water supply trunk main to connect the Northern and Central water supply networks. In order for this to occur a supply to the West Perth network is required from the Mt Eliza reservoir by way of a pump station. As such the Water Corporation proposes to construct the following works;

- A booster pump station of reinforced concrete walls being approximately 11m long x 6m wide x 3.5m high. The roof structure will be of metal colorbond that will slope in one direction to provide a total height that varies from approximately 4.5m to 3.5m.
- Electrical work such as an above ground roofed emergency generator and switchboard in a cabinet,
- Pipework such as a below ground flow meter arrangement in a pit and an above ground pressure reducing valve arrangement in a cabinet,
- Various buried water pipelines such as approximately 80 metres of 300mm nominal diameter and 90 metres of 150mm nominal diameter,
- Connect to existing buried pipelines,
- Upgrade existing perimeter fence line,
- Colours and architectural treatment of above ground works (including building) to be agreed with the Botanic Gardens and Parks Authority,
- Revegetation, and
- Decommission an existing below ground pressure reducing valve arrangement in a pit.

The location of the proposed works is as shown in the plans.

Subject to obtaining all necessary approvals, the proposed works are scheduled to commence early 2026 and will take approximately 4 months to complete.

Further information may be obtained by contacting the Project Manager, Mrs Lizelle Muntz, telephone (08) 9420 3623 during office hours or by email at [lizelle.muntz@watercorporation.com.au](mailto:lizelle.muntz@watercorporation.com.au).

Objections to the proposed works will be considered if lodged in writing, addressed to the Project Manager Mrs Lizelle Muntz, Water Corporation, PO Box 100, Leederville WA 6902, before the due date stated in the accompanying letter.

PRELIMINARY NOT FOR CONSTRUCTION 11/04/25 14:35

|       |      |      |          |     |     |      |                       |                            |                              |             |                              |  |  |                     |           |
|-------|------|------|----------|-----|-----|------|-----------------------|----------------------------|------------------------------|-------------|------------------------------|--|--|---------------------|-----------|
| ISSUE | DATE | GRID | REVISION | DRN | REC | APPD | DESIGN SURVEY<br>NONE | VERTICAL DATUM<br>NONE     | DES CALC<br>G DUNSTAN        | NORTH POINT | RECOMMENDED                  |  | METROPOLITAN WATER<br>500MM DIST MAIN - MT ELIZA RESERVOIR TO KINGS PARK RD<br>PREREQUISITES TO WORK<br>NOTICE OF PROPOSAL - GENERAL WORKS | ORIGINAL SHEET SIZE |           |
|       |      |      |          |     |     |      | ASCON SURVEY<br>NONE  | COORDINATE SYS<br>MGA20-50 | DES CHD                      |             | PRINCIPAL ENGINEER, MECH DES |  |  | FILE                | A1        |
|       |      |      |          |     |     |      |                       | DES REF<br>NONE            | DRN<br>F RACCUJA<br>Q.C. CHD | APPROVED    | TEAM LEADER, MECH DES        |  |  | PLAN                | 16990-0-3 |