

4000Ltr GREASE ARRESTOR LAYOUT - BELOW GROUND

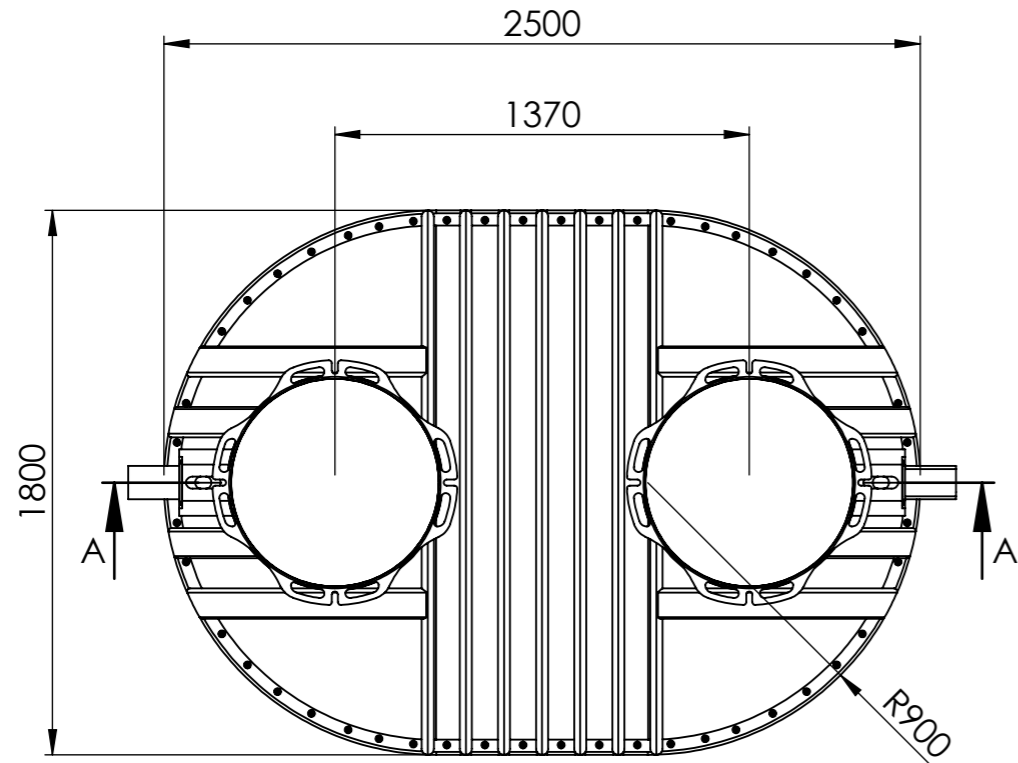

TOP VIEW

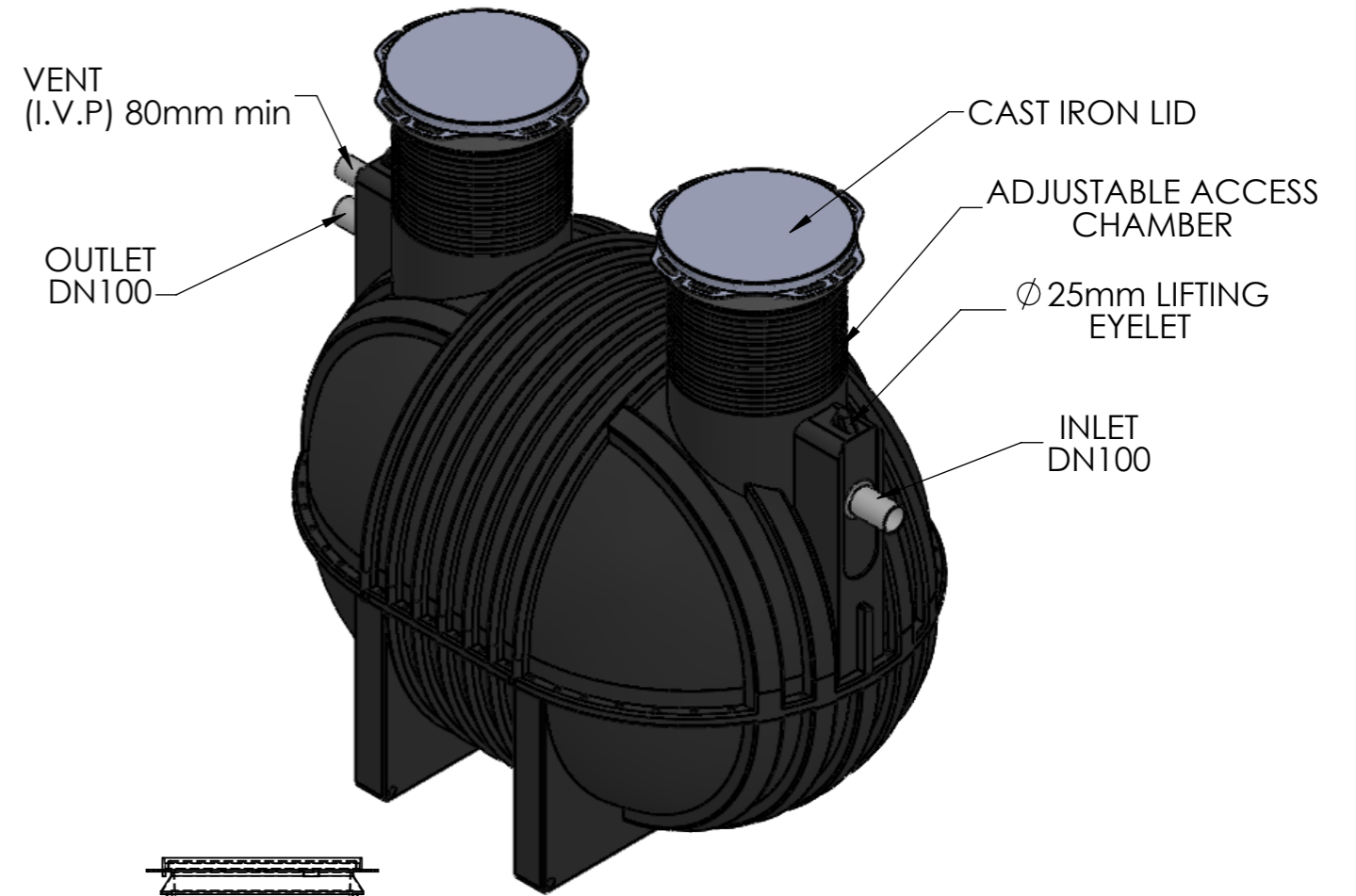

PERSPECTIVE VIEW

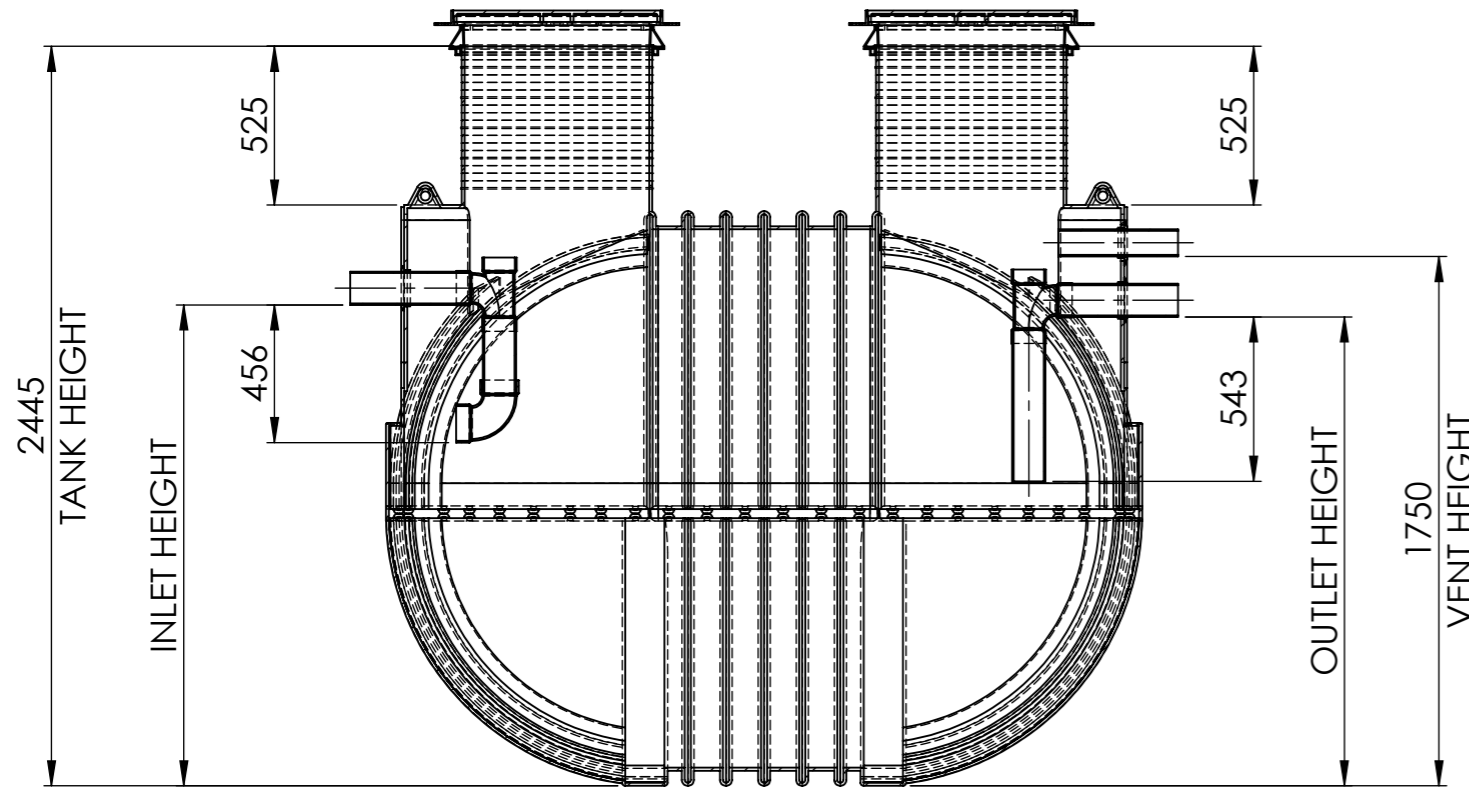

SECTION A-A

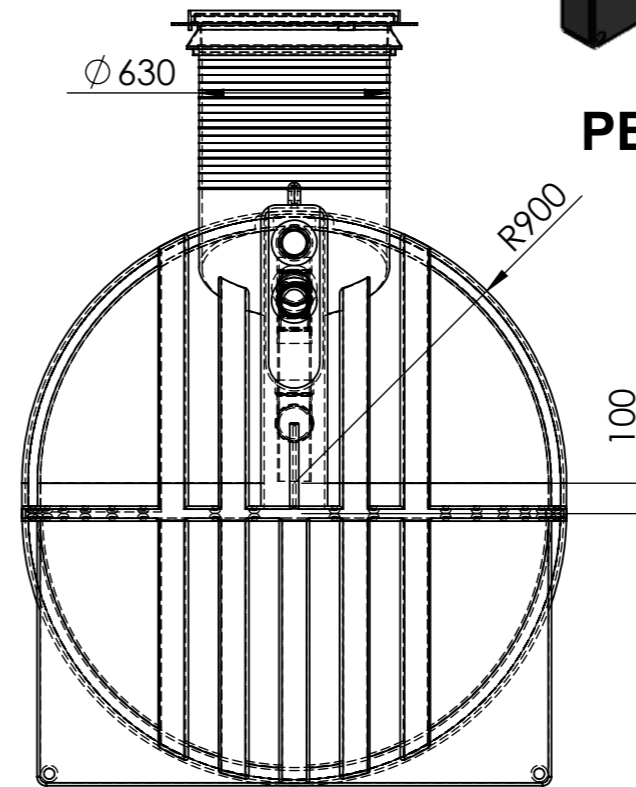

SIDE VIEW



DATE	27JUL2022	MATERIAL	LDPE	REVISIONS				SHEET 1 OF 2	
PRODUCT	4000Ltr Grease Arrestor	SURFACE FINISH	-		01	LB	20SEP2022	REPLACED DN100 TO I.V.P 80mm	CHKD
PRODUCT CODE	GA4000	WALL THICKNESS	-		01	MI	27JUL2022	ISSUED FOR CONSTRUCTION	APVD
DRAWING No	C-GA4000-001	SCALE	NTS		REV	BY	DATE	DESCRIPTION	SHEET SIZE

© THIS DRAWING IS THE COPYRIGHT OF COERCO. IT CANNOT BE COPIED IN PART OR FULL WITHOUT THE WRITTEN PERMISSION OF COERCO

A3

4000Ltr GREASE ARRESTOR LAYOUT - BELOW GROUND

This document must be read in conjunction with Water Corporation Plans HX33-10-00, HX33-11-30 and HX33-10-10. Lids located in trafficable areas must meet the requirements of AS/NZS 3996 and be supported with concrete to ensure no additional forces are applied to the tank.

NB: PIPEWORK IN THIS DRAWING FOR ILLUSTRATION PURPOSES ONLY. PLEASE REFER TO YOUR STATES ISSUED LAYOUT DRAWING FOR CORRECT LAYOUT.

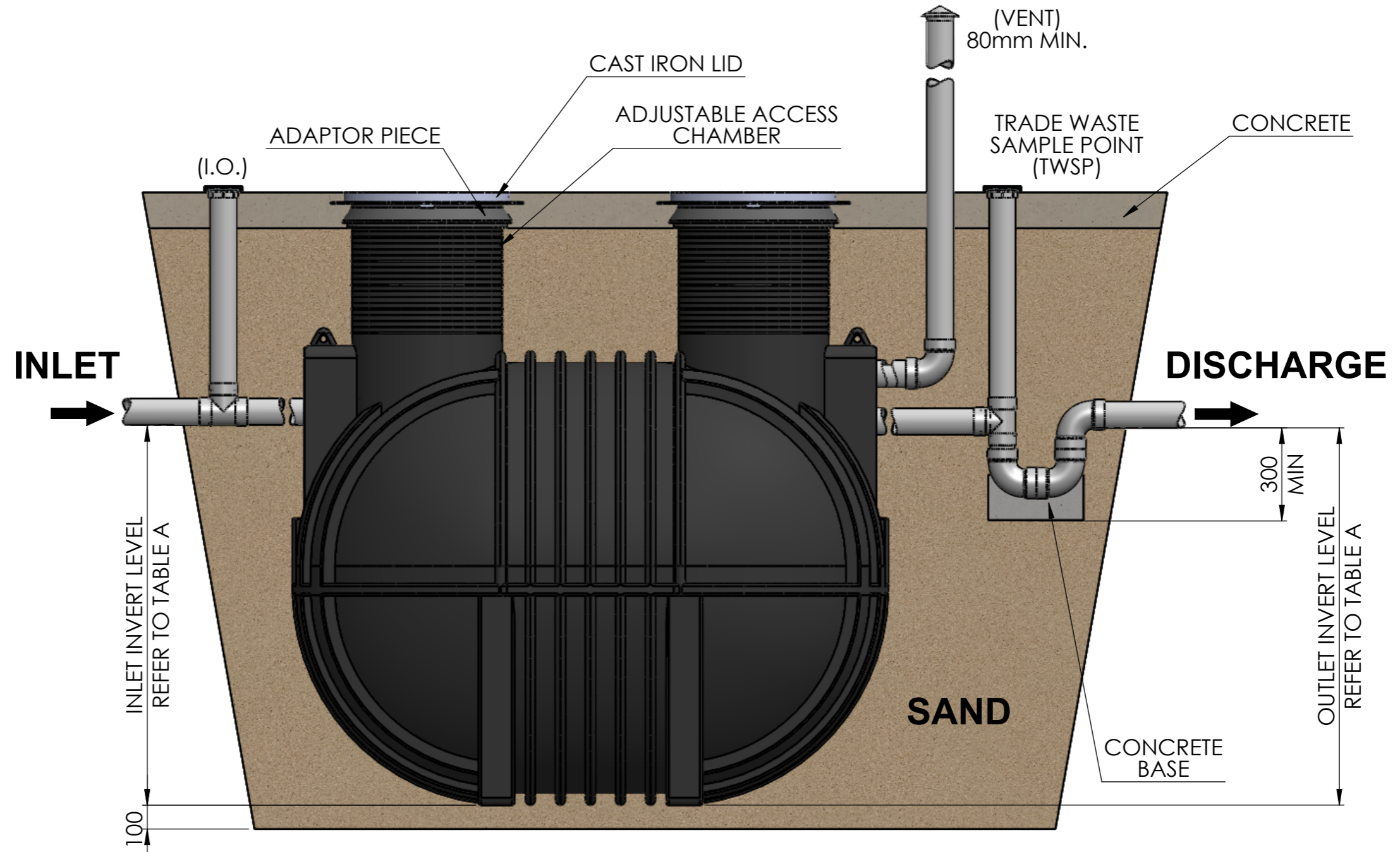

DATE	27JUL2022	MATERIAL	LDPE	REVISIONS					SHEET 1 OF 1
PRODUCT	4000Ltr Grease Arrestor	SURFACE FINISH	-						CHKD
PRODUCT CODE	GA4000	WALL THICKNESS	-						APVD
DRAWING No	C-GA4000-002	SCALE	NTS	01	MI	27JUL2022	ISSUED FOR CONSTRUCTION		SHEET SIZE A3
© THIS DRAWING IS THE COPYRIGHT OF COERCO. IT CANNOT BE COPIED IN PART OR FULL WITHOUT THE WRITTEN PERMISSION OF COERCO									