

D1 Grease Guardian Specifications

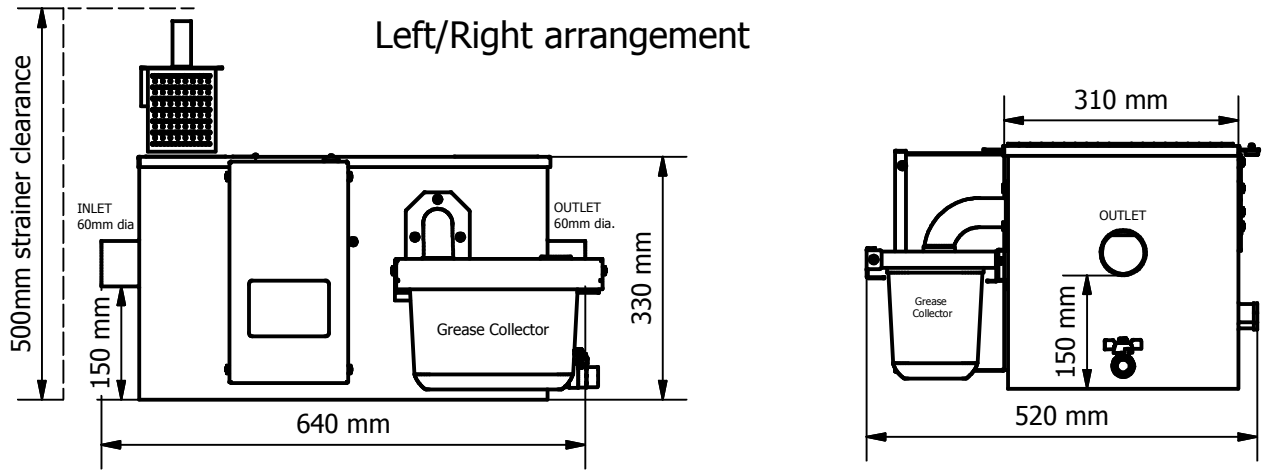

Right/Left Arrangement
All dimensions to be mirrored for Right/Left Arrangement

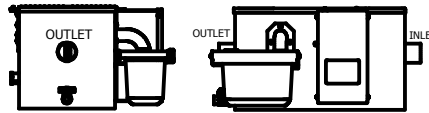

Minimum Footprint Dimensions

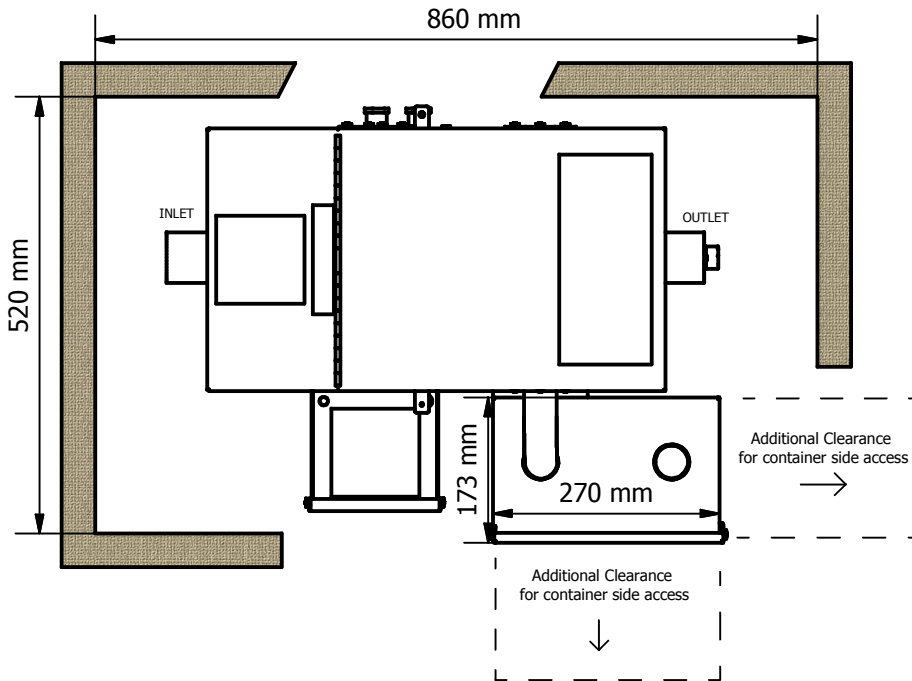

Allow for the minimum clearances shown

Allow additional 150mm length clearance for outlet sampling port where applicable

Grease Collector is front loading/side loading optional. Standard supply is front loading

TECHNICAL DATA

| | |
|---------------------------|---|
| Weight | 29 KG |
| Material | Exterior, 16 gauge stainless steel, bright finish |
| Interior | Stainless Steel and Acetal Plastic Components |
| Maximum Flow Rate | 0.75 litres per second |
| Number of skimming wheels | 1 to 3 optional |
| Solid Strainer Capacity | 3 litres |
| Skimming Rate | 12 kg per hour/wheel |
| Programming/Control | 24 hour, 7 day, multi functional digital |
| Electrical Load | 230VAC, 1024 Watts 4.46 AMPS |